

# KINGSLEY BATE™

ELEGANT OUTDOOR FURNITURE

## ASSEMBLY INSTRUCTIONS FOR THE PV-24/42

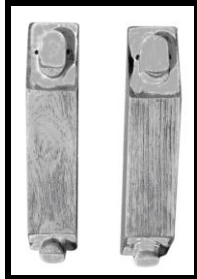

**ANGLE SUPPORTS**

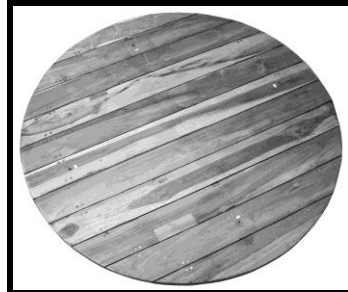

**TABLE TOP**



**TABLE BASE**

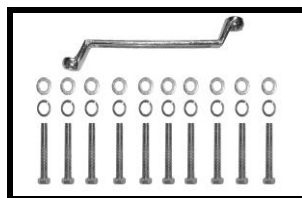
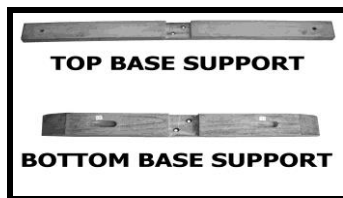

**HARDWARE**

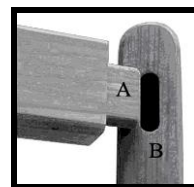

**\* NOTE**

**A TENON**

**B MORTISE HOLE**

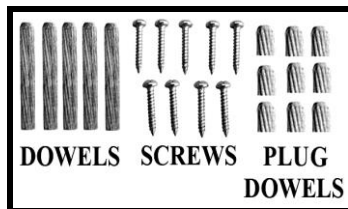

### **STEP-I**

Unpack, inspect and lay the parts on a clean, flat, soft surface to avoid marring the wood.

**NOTE:** During assembly of the furniture please match all joints with the corresponding letters or numbers stamped on the furniture.

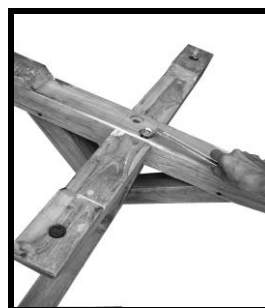

### **STEP-II**

Flip the TABLE BASE upside down and with the help of another person carefully install the ANGLE SUPPORTS and the BOTTOM BASE SUPPORT as shown in the

assembly pictures (use of a rubber mallet may be necessary to drive all joints together). **NOTE: ANGLE SUPPORTS, TABLE BASE and BOTTOM BASE SUPPORT are all marked with letter and/or numbers for accurate assembly.** Once all joints fit snugly together secure the BOTTOM BASE SUPPORT with the knock down bolts and washers provided. **NOTE: Slide the split washer on first followed by the flat washer onto the bolt).**



### STEP-III

Flip **BASE ASSEMBLY** right side up and insert screws into respective pre-drilled holes at the **ANGLE SUPPORT** as shown in the assembly photograph. Do not hammer in the screws, but drive

them in with a proper screw driver. Hammer plug dowels into place as shown in assembly photographs. Drive the wooden dowels through the tenons of the **BOTTOM BASE SUPPORT** and **ANGLE SUPPORT**; to avoid marring the wood we suggest you use a wood block between the hammer head and the dowel head for the last few blows.



### STEP-IV

Assemble **TOP BASE SUPPORT** to the **BASE ASSEMBLY** with the knock down bolts and washers provide (see **STEP-II**). **NOTE:** Please notice stamped letters

and/or numbers on your **TABLE TOP** and **TOP BASE SUPPORT** so they match and line up properly.

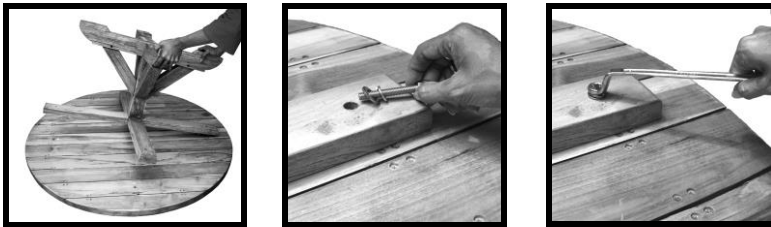

### STEP-V

Lay **TABLE TOP** upside down on a clean, flat, smooth surface. Flip **BASE ASSEMBLY** onto **TABLE TOP** and matching the markings secure with hardware and tool

provided (again, slide the split washer on first followed by the flat washer).

IF YOU HAVE ANY QUESTIONS REGARDING THE ASSEMBLY OF YOUR KINGSLEY BATE FURNITURE, PLEASE CONTACT THE KINGSLEY BATE DEALER NEAREST TO YOU OR KINGSLEY BATE DIRECTLY. WE THANK YOU FOR CHOOSING OUR FURNITURE.

*\*KINGSLEY-BATE WILL NOT TAKE RESPONSIBILITY FOR DAMAGE IF THESE INSTRUCTIONS ARE NOT FOLLOWED PROPERLY.*